

Worksurface height adjustment addresses issues of ergonomics, multi-person use, and changing project requirements. IAC offers convenient retrofit kits to bring either manual or motorized worksurface height adjustability to Dimension 4 Workstations and any 4-leg workbench, such as IAC's Isles Series or EZE Workmaster. Both the manually- and electrically-actuated kits utilize durable and dependable hydraulics to provide smooth, infinite adjustment within their overall range of movement.

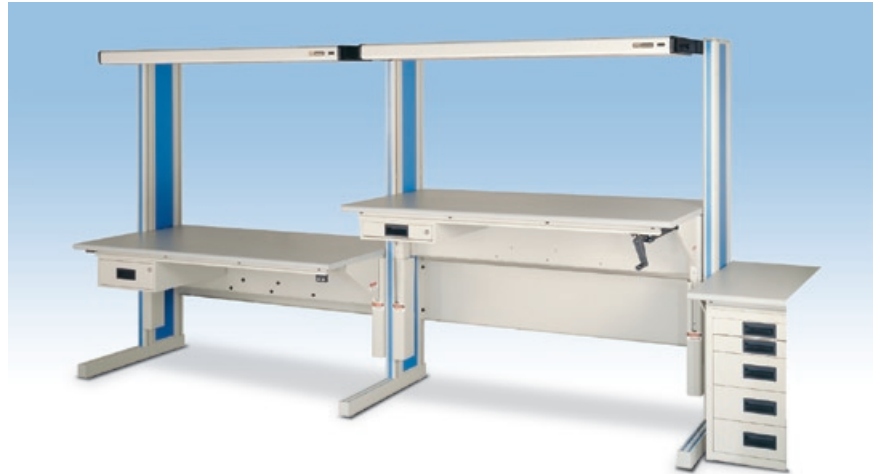

IAC Dimension 4 Retrofit Kits – Single-Side Workstations

- 12-inch height adjustment travel
- 500 lbs. lifting capacity

These hydraulically-adjustable height kits will retrofit existing single-sided* Dimension 4 workstations with little alteration to existing parts. Choose from either manual hand-crank actuation or push-button motorized actuation. Both kits provide smooth, infinite height adjustment throughout their 12-inch range of travel. Kits are supplied with all components required.

*Double-sided workstation kits are also available; please contact factory.

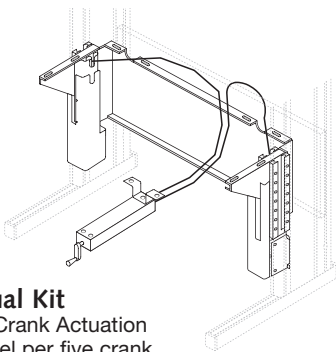

Manual Kit
Hand Crank Actuation
(1" travel per five crank revolutions)

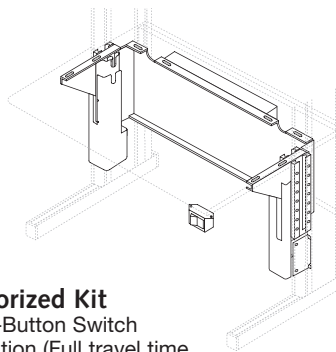

Motorized Kit
Push-Button Switch Actuation (Full travel time approximately 32 seconds)

Order by Part Number

- Kits for stand alone workstations utilize the customer's existing worksurface; no new worksurface is supplied.
- Kits for inline workstations are supplied with new worksurfaces featuring pinch-point relief on their sides. Specify these units whenever two or more workstations are connected inline.

Ordering Tips from IAC

- 1 With adjustable height units, take into account other options to be mounted on the workstation. Items such as electrical channels and electrical services in the uprights, footrests, shelving, CRT platforms, etc. may reduce the usability of the 12" adjustment range. Please consult with an IAC representative for best results.
- 2 Consider motorized hydraulic adjustable height option when frequent height adjustments are needed.
- 3 To maintain maximum weight bearing capability of adjustable height worksurfaces, IAC recommends the use of rolling cabinets for workstation storage rather than suspended cabinets and drawers. The weight of the suspended cabinets and drawers, plus their contents, will reduce the maximum weight capacity of the worksurface.

For Stand-Alone Workstations

Uses existing worksurface.

Length	Depth	Manual	Motorized
48"	30"	2013711	2013611
	36"	2013721	2013621
60"	30"	2013712	2013612
	36"	2013722	2013622
72"	30"	2013713	2013613
	36"	2013723	2013623

For In-Line, Multi-Unit Systems

Supplied with new worksurface; specify laminate color (contact factory for options).

Length	Depth	Manual		Motorized	
		Std. Laminate	ESD Laminate	Std. Laminate	ESD Laminate
48"	30"	2014711	2015211	2014811	2015311
	36"	2014721	2015221	2014821	2015321
60"	30"	2014712	2015212	2014812	2015312
	36"	2014722	2015222	2014822	2015322
72"	30"	2014713	2015213	2014813	2015313
	36"	2014723	2015223	2014823	2015323

IAC 4-Leg Workbench Retrofit Kits

- 12-inch height adjustment travel
- 700 lbs. lifting capacity

These bolt-on systems are easy to install and adjust workbench height to each person or task. They install with common tools on 4-leg workbenches, platforms and desks. Each IAC Height Adjustment Retrofit Kit is supplied with everything needed to install.

Optimum Height Pays Off with Better Productivity

The best way to improve productivity and reduce physical injury is to enable users to adjust their working surface to correspond with their physical requirements. IAC Retrofit Kits allow 12 inches of height adjustment and are capable of operating with loads up to 700 lbs.



Improper worksurface height puts a strain on the back and joints of users, providing a poor working environment.



Adjustable height kits allow each user to find the best worksurface position for comfortable and stress-free production.



Make your workbenches multi-user, multi-task and multi-purpose ready with an IAC Height Adjustment Retrofit Kit.

Manual Kit
Hand Crank Actuation



Motorized Kit
Rocker Switch Actuation



Both manual and motorized kits are shipped assembled as shown with some minor final assembly required.

Kit Contents

- Hand crank or motor driven actuator unit
- Two 8-ft. sections of flexible tubing
- Two 10-ft. sections of flexible tubing
- Four lift cylinders
- Four glides
- Twelve tubing clips (adhesive backed) and sixteen cable ties
- Attachment brackets and hardware
- Installation tips
- Drilling templates

Order by part number

4-Leg Workbench Retrofit Kits	
Actuation Method	Part Number
Manual	1005981
Motorized	1005982

IAC is Home to these quality products...

- Dimension 4
- Pro Series
- Isles Series
- LAN Workstations
- AirClean™ Laminar Flow Benches
- Cleanroom Products
- Multi-Task System (MTS) Upper Structures
- EZE Workmaster™ Workbenches
- Spacestation™ Workstations
- Kinatechnics System 1
- Packaging Stations
- Task Handling System™ (THS) Workstations & TaskMate™ Upper Structures
- Material Handling Carts, Accessory Stations, Gravity Feed Racks & Conveyor Systems



895 Beacon Street • Brea, CA 92821-2926
Tel 714-990-8997 • Fax 714-990-0557

www.iacindustries.com